

## THE VOTE AND PUBLIC COST

- The proposed building project's all-inclusive budget is \$14,300,000.
- On February 27, 2017, the school board approved a bond resolution asking for a public vote.
- The ballot asks permission for the school to issue up to \$14,300,000 in debt to pay for a building project.

## NEXT STEPS

- Additional resources and materials are available on the school's website: <http://www.maple-valley.k12.nd.us/> on the building project page. Look for the "ICON" button similar to the one shown here and click on it.



Hard copies of all materials can be obtained at the High School in Tower City.

- **Please vote on April 25, 2017 at the Tower City Community Center. Hours are: 7:00am - 7:00pm.**

## WHY NOW?

- **Educational and Community Benefits**
  - Brings our students and staff together
  - Will serve this and future generations
  - Improve access to technology
  - Allows training of "real world" skills
  - Purpose built classrooms for 21st Century learning
    - Collaboration
    - Critical Thinking
    - Creativity
    - Communication
  - Multi-purpose areas make better use of space
    - Serves our handicapped and special needs students
  - Less wasted time for students/teachers – travel, etc.
- **Financial Benefits**
  - Invest tax payer money towards our future vs. maintaining older buildings
  - Save at least \$132,000 per year in operational costs
  - Bond interest rates are at 30 year lows
  - State low interest (2%) loan is available
  - Construction costs are likely to rise. They are very competitive now



Maple Valley Public School North Entrance  
Rendering by ICON Architectural Group

## WHAT WILL IT TAKE?

For the \$14.3 million project, the estimated increase is 49.15 mills. Examples include:

	True & Full Value	Per Year	Per Month
Cropland Average (Cass County)	\$968	\$2.38 per acre	
Cropland Average (Barnes County)	\$916	\$2.25 per acre	
Non-Cropland Average (Cass County)	\$235	\$0.58 per acre	
Non-Cropland Average (Barnes County)	\$171	\$0.42 per acre	
Residential Average (Cass County)	\$202,600	\$448	\$37.34
Residential Average (Barnes County)	\$66,787	\$147.72	\$12.33

**You can calculate your specific tax impact using the following formulas:**

Cropland Example from above:  $\$968 \times .050 \times 49.15/1000 = \$2.38$  per acre annually

Residential Example from above:  $\$66,787 \times .045 \times 49.15/1000 = \$147.72$  per year

What is your Vision for the Future of the Maple Valley School District?  
***We believe our best days are ahead of us!***



**MAPLE VALLEY PUBLIC SCHOOL**  
www.maple-valley.k12.nd.us  
(701) 749-2570



# MAPLE VALLEY PUBLIC SCHOOL FACT SHEET

ICONARCHITECTS.COM/MAPLEVALLEY



Maple Valley Public School Main South Entry  
Rendering by ICON Architectural Group

## THE PROCESS AND ACTIONS TO DATE

- The School Board created a committee of community members, school board members and administration. The Citizen's Committee looked at all community input and collected data to come up with a solution, to the specific concerns stated below, that best serves all students and patrons of Maple Valley School District.
- The school board specifically charged the Citizen's Committee to:
  - Address operating costs and future maintenance concerns
  - Consider facility improvements
  - Prioritize > consider tax impact and operating costs
  - Look at all options
  - Recommend an option that you feel will gain voter support
  - Project must be sustainable > look out 10+ years
  - Get the information you need for a recommendation to the school board
- The Citizen's Committee met over several months, created a facility solution, presented solution in town hall and open house formats, received feedback and made a recommendation to the school board based on community feedback.
- School board received the Citizen's Committee recommendation. The board accepted their recommendation and called for a public vote on September 20, 2017. On that date, voters approved exceeding the school district's 5% debt limit question. The question to sell bonds for the \$14.3 million project was approved by 59.7% of the voters, just short of the 60% required to pass
- After hearing continued support for this plan, and with continued low interest rates and construction costs, the school board called for another referendum vote on April 25, 2017.

## CURRENT EDUCATIONAL FACILITIES

Facility assessments identified the current state of all three buildings. The review covered structural, electrical, mechanical, safety, ADA and Department of Public Instruction educational minimum space requirements.

Listed below are the costs for the current building maintenance needs due within 5-10 years that include changes that will be mandatory to meet code:

- **Oriska** - \$3.1 million, \$158 per SF, 77% of cost of building new.
- **Buffalo** - \$ 2.0 million, \$146 per SF, 71% of cost of building new.
- **Tower City** - \$2.9 million, \$101 per SF, 49% of cost of building new.

## POSSIBLE SOLUTION

- The Citizen's Committee collaborated with the architects, engineers and construction managers to address the districts needs. Together they worked through more than 10 design variations. They also looked at building a new school.
- The recommended solution provides every student with an enhanced learning environment with special attention paid to safety, security, and a plan to handle potential growth in the future.
- The committee worked through the community feedback that was received to make their final recommendation to the school board which encompasses 50,825 square feet of new construction with 14,750 sq. ft. of renovation on the current school in Tower City.

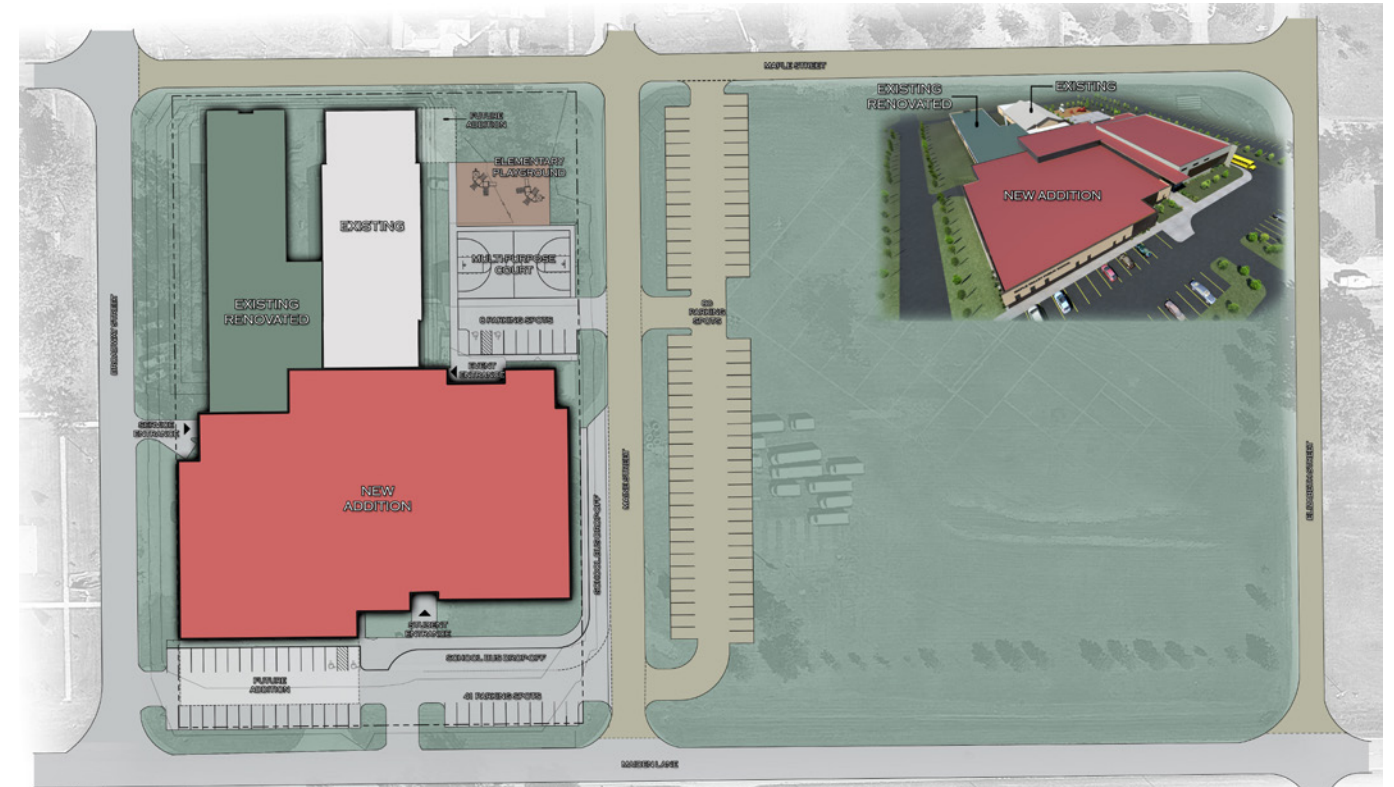

Maple Valley Public School Site and Floor Plans  
by ICON Architectural Group