

STATE	PROJECT NO.	SECTION NO.	SHEET NO.
ND	UGP-2-990(068)	4	1
SU-CPU-2-990(069)			

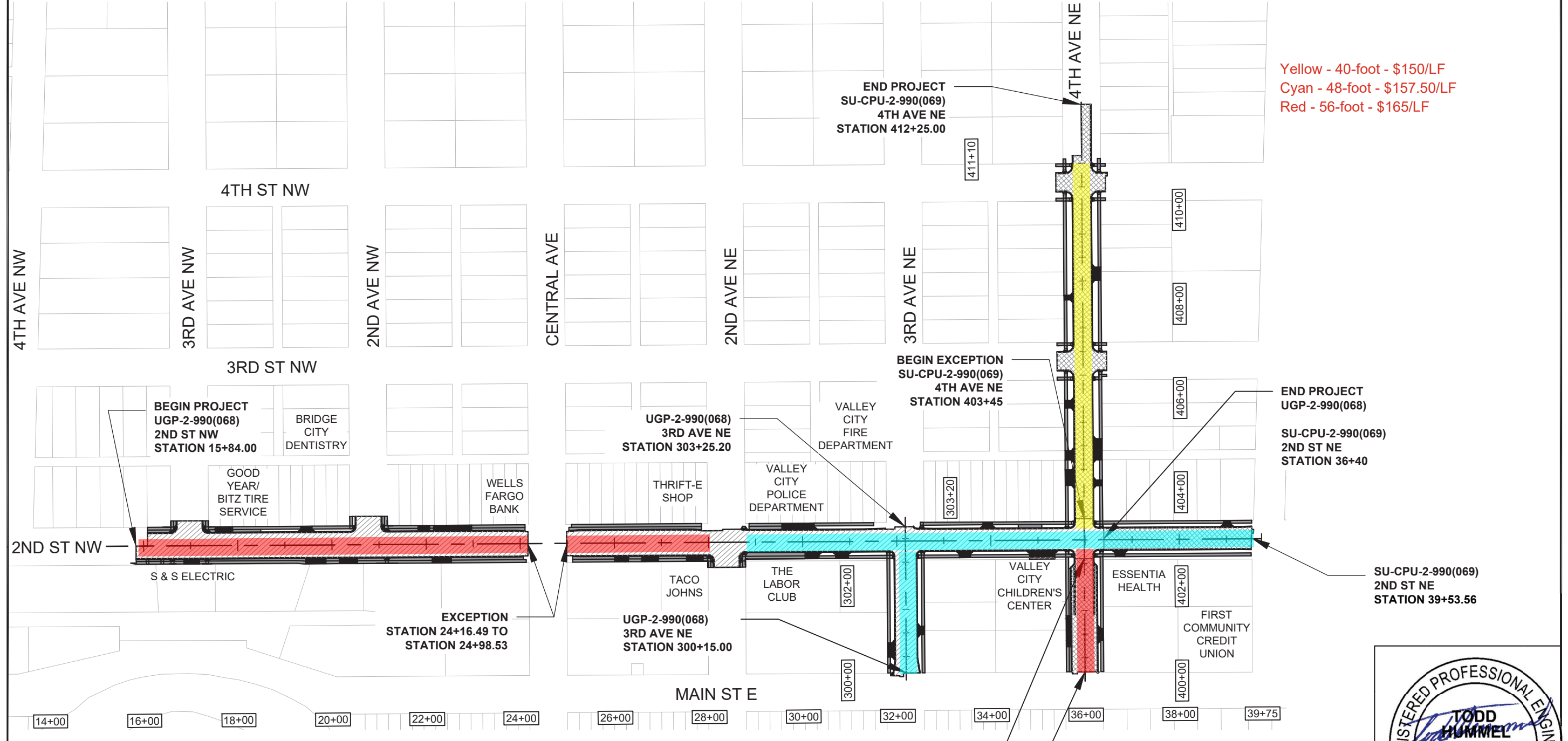

Yellow - 40-foot - \$150/LF  
 Cyan - 48-foot - \$157.50/LF  
 Red - 56-foot - \$165/LF

**LEGEND**

	SIDEWALK CONCRETE, PIGMENTED SIDEWALK CONCRETE & SALVAGED BASE COURSE
	SUPERPAVE FAA 43 & SALVAGED BASE COURSE - UGP
	SUPERPAVE FAA 43 & SALVAGED BASE COURSE - SU-CPU
	DRIVEWAY CONCRETE & SALVAGED BASE COURSE

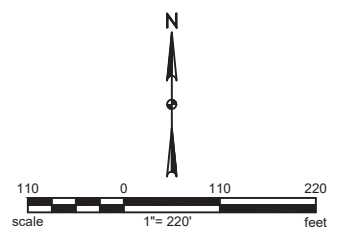
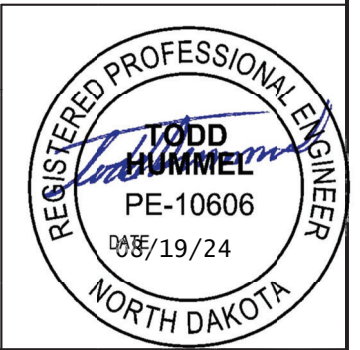

**STREET RECONSTRUCTION**  
 CITY OF VALLEY CITY, NORTH DAKOTA

**KLJ**

**SCOPE OF WORK**

DRWN. BY TW	CHKD BY KH	PROJECT NO. 2304-01676
----------------	---------------	---------------------------