

Installation Instructions

Model G22 Series

APPLICATION	Intended Use: Installation:	Sound masking, music, and paging Fits into a 2' x 2' or 2' x 4' ceiling tile grid
CERTIFICATION	UL Listed 1480A (Type G): UL Listed 2043:	When installed per supplied installation instructions and requirements of NEC/AHJ Suitable for use in air-handling spaces. Material and construction permits use where ceiling plenum is part of the air handling system

INSTALLATION INSTRUCTIONS

- Cut ceiling tile as required:
2' x 2' tile – No cutting required.
2' x 4' tile – Cut tile in half on 4' side.
- Required only if using "-C" models.
 - Loosen, but do not remove screws** on entry box to remove cover plate.
 - Remove knockout from desired location;** Install UL Listed metallic enclosure entry fitting for plenum cable or flex whip.
 - Feed supply cable through whip to speaker wires.** Terminate wire with RJ45 Pinout T-568B. Use appropriate connectors to meet any required codes.
 - Replace cover plate and tighten cover plate screws. When cover plate is secured, all connections/splices must be inside of the enclosure.
- Make the necessary field wiring connections.
 - Connect the OP speaker output to either speaker RJ45 connector.
 - Connect the other speaker RJ45 connector to either RJ45 connector on next speaker if applicable.
 - Maximum of 11 speakers permitted on any speaker run.
- Place assembly onto ceiling grid, install 24" T-bar trim piece where required (not supplied).

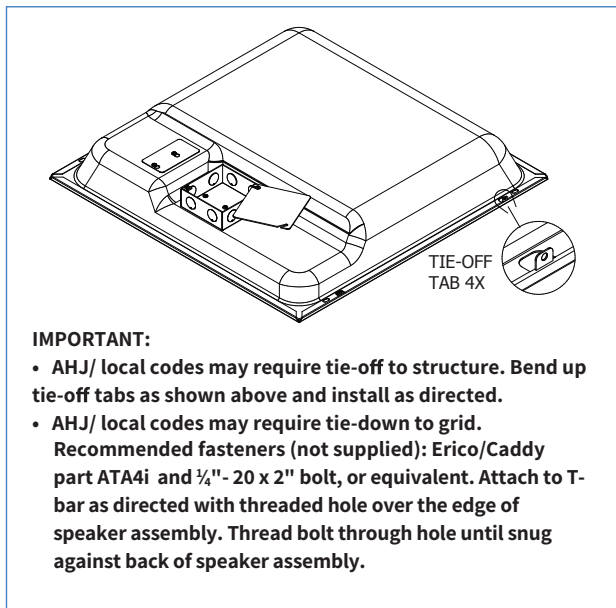

IMPORTANT:

- Verify all code requirements with local AHJ before selecting connection method.
- Using code compliant connectors for all field wiring.

- Place remaining ceiling tile into grid opening as required.